

C. 71-73

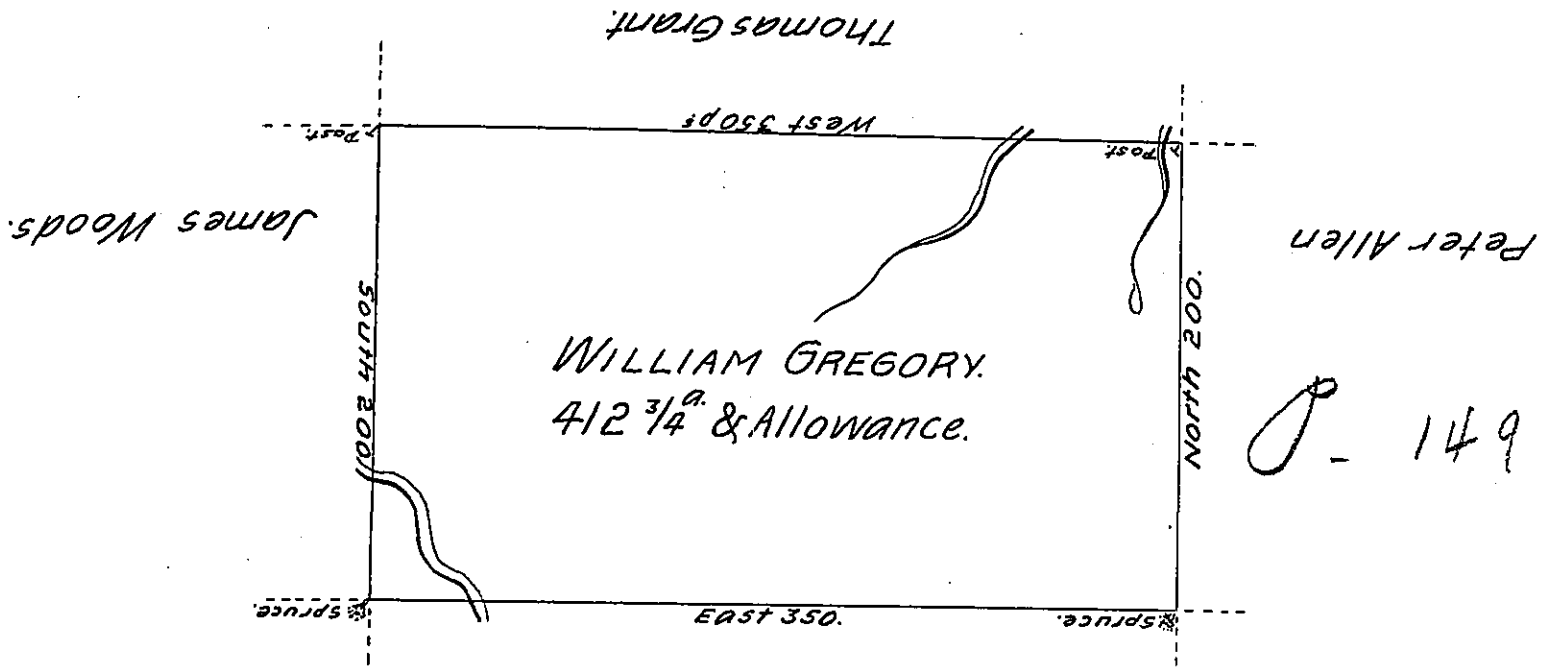

Jacob S. Howell
C. 95-192

A Draught of a Tract of Land Called, _____ Situate Adjoining Land of
 Jacob S. Howell, and others. & laying on the Waters of Snake Creek, in
 Stoke Township, \pm Northumberland County, Surveyd on the 28th day of
 Sep^r 1787 ~~to~~ for William Gregory, by Virtue of his Warrant dat^d the
 27th day of July 1787. Containing four Hundred and Twelve Acres and $\frac{3}{4}$ ^{ths}
 and allowance of Six p. Cent for Roads &c.

by

To John Lukens Esq^r } W^m Gray D. S.
 Surveyor Gen^l } - now Luzerne County.

IN TESTIMONY that the above is a copy of the original remaining on file in
 the Department of Internal Affairs of Pennsylvania, made
 conformably to an Act of Assembly approved the 16th day of
 February, 1833, I have hereunto set my Hand and caused
 the Seal of said Department to be affixed at Harrisburg,
 this eighth day of December 1904.

Loac B. Brown
 Secretary of Internal Affairs.